

Heavy Duty Spacer Coupling GCH Series - Form-Flex®

Double Flex Spacer

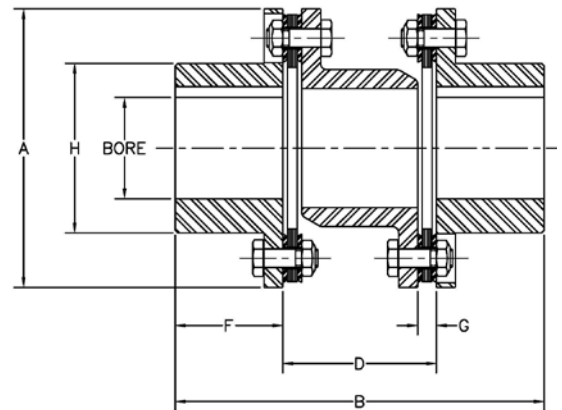

Size	Spacer	Max Bore		Dimensions (mm)					
		(mm)	(in)	A	B	D	F	G	H
340	31	100	3.75	212.9	251.2	105.2	73.2	14.5	138.2
	35				265.7	119.6			
412	42	120	4.50	279.4	357.4	141.5	108.0	19.1	165.4
	45				370.1	154.2			
	50				398.5	182.6			
424	55	190	6.88	381	506.7	189.2	158.8	24.9	243.1
	60				532.1	214.6			
456	70	220	8.00	457.2	612.9	244.6	184.2	33.5	295.4
	75				640.1	271.8			
511	80	280	10.00	558.8	746.5	289.3	228.6	39.6	368.3
	85				771.9	314.7			
	92				810.0	352.8			

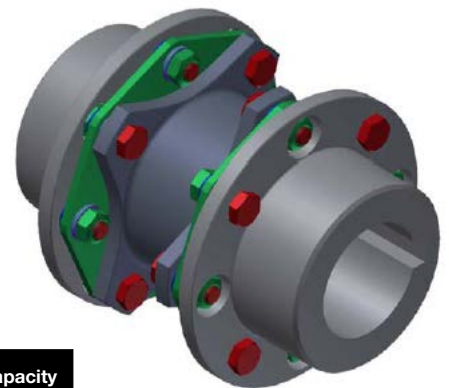

Size	Spacer	Rated Torque		Peak Overload (Nm)	Max RPM	Weight (1) (kg)	WR ² (1) (kg-m ²)	Misalignment Capacity	
		kW/100 RPM	(Nm)					Axial (+/- mm)	Angular (Degrees/Disc Pack)
340	31	48	4,519	6,779	3,400	19.5	0.101	1.52	0.33°
	35					20.0	0.102		
412	42	142	13,558	20,337	2,500	48.0	0.401	2.03	
	45					49.0	0.405		
	50					50.8	0.414		
424	55	283	27,116	40,673	1,800	126	2.09	2.54	
	60					129	2.12		
456	70	663	63,270	94,905	1,500	239	5.71	3.05	
	75					244	5.79		
511	80	1,303	124,280	186,420	1,200	437	15.91	3.56	
	85					444	16.10		
	92					503	18.85		

Note: Couplings available for torque capacity up to 1129815 Nm. Contact Altra Couplings engineering with application details for coupling selection.

STANDARD MATERIALS

HUBS - CARBON STEEL

SPACER - DUCTILE IRON

HARDWARE - ALLOY STEEL

DISC PACKS - HIGH CARBON STEEL

MATERIAL / FINISH OPTIONS

DISC PACKS - STAINLESS STEEL

ZINC PHOSPHATE COATING

ALLOY STEEL HUBS

STEEL SPACER

NOTES:

- 1) Weight and WR² are calculated with hubs at maximum inch bore size.
- 2) Consult factory for torsional stiffness and alternating torque limits.

ORDERING

GCH SERIES COUPLINGS ARE SOLD AS COMPLETE ASSEMBLIES

- 1) Specify coupling size and spacer option

Example: GCH424-60 85 MM X 120 MM

- 2) Specify hub bore size and tolerance, keyway size or keyless, special hub length, etc. Please specify for each hub.