

SINGLE FLEX - BH SERIES 6 BOLT SINGLE FLEXING COUPLING

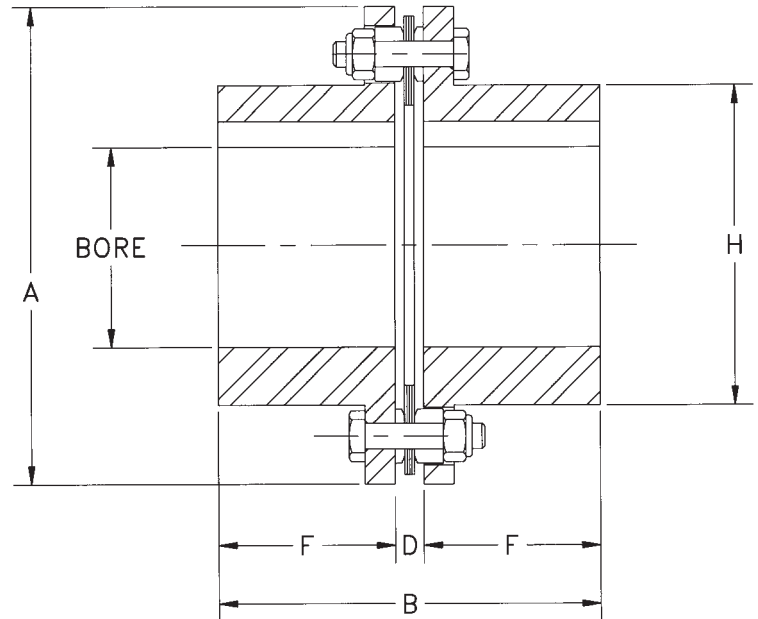

The BH series coupling accommodates angular and axial misalignment only. Single couplings may be used in pairs to support a clutch, brake or other power transmission component in a floating shaft arrangement, or to support a component that is supported by a self-aligning bearing. The BH coupling consists of two hubs and one set of standard hardware, including stainless steel flex discs.



RATED MISALIGNMENT: 0.7 DEG/DISC

| SIZE | DIMENSIONS IN INCHES | | | | | |
|------|----------------------|-------|------|--------|------|------|
| | MAX BORE | A | B | D DBSE | F | H |
| 33 | 2.25 | 4.69 | 3.79 | 0.29 | 1.75 | 3.14 |
| 38 | 3.00 | 5.87 | 4.84 | 0.34 | 2.25 | 4.13 |
| 43 | 3.25 | 6.70 | 5.47 | 0.47 | 2.50 | 4.63 |
| 48 | 3.75 | 7.50 | 6.00 | 0.50 | 2.75 | 5.40 |
| 53 | 3.88 | 7.87 | 6.28 | 0.52 | 2.88 | 5.65 |
| 58 | 4.25 | 9.00 | 7.06 | 0.56 | 3.25 | 6.22 |
| 63 | 4.88 | 10.00 | 7.36 | 0.60 | 3.38 | 7.14 |
| 68 | 5.00 | 10.75 | 8.35 | 0.85 | 3.75 | 7.33 |

| HUB TYPES | SIZES |
|---------------|-------|
| BH | 33-78 |
| SEE PAGE F5-9 | |

| MATERIAL CLASSES | | FLEX ASSY PART # |
|------------------|-----------|------------------|
| CLASS | SIZE | |
| A | 33-78 | BOxxRKA |
| B | 33-78 | BOxxRKA |
| C | 38-63 | BOxxRKE |
| E | MTO 38-63 | BOxxRKE |
| SEE PAGE F5-4 | | xx = SIZE |

COUPLING CONSISTS OF:
 2 – HUBS – EXAMPLE- BH48Ax3”
 1 – FLEX ASSEMBLY – EXAMPLE- BO48RKA
 THIS COUPLING IS SOLD AS COMPONENTS

| SIZE | HP PER 100 RPM | RATED TORQUE (lb. in.) | PEAK O/L TORQUE (lb. in.) | AGMA 8 MAX RPM | MAX RADIAL LOAD (lbs.) | WEIGHT (lbs.) | WR ² (lb. in. ²) | TQ/RAD X10 ⁶ (lb. in./rad) | FREE END FLOAT +/- inch |
|------|----------------|------------------------|---------------------------|----------------|------------------------|---------------|---|---------------------------------------|-------------------------|
| | 1.0 S.F. | | | | | | | | |
| 33 | 4.84 | 3,050 | 6,100 | 8,400 | 150 | 5.76 | 14.5 | 4.57 | 0.03 |
| 38 | 10.08 | 6,350 | 12,500 | 7,500 | 240 | 11.4 | 46.6 | 9.41 | 0.04 |
| 43 | 19.84 | 12,500 | 25,000 | 6,800 | 420 | 17.3 | 91.7 | 17.8 | 0.05 |
| 48 | 26.98 | 17,000 | 34,000 | 6,500 | 655 | 25.2 | 171 | 25.5 | 0.06 |
| 53 | 38.10 | 24,000 | 48,000 | 6,000 | 720 | 29.8 | 226 | 29.8 | 0.06 |
| 58 | 53.97 | 34,000 | 68,000 | 5,500 | 930 | 45.4 | 443 | 50.0 | 0.06 |
| 63 | 76.19 | 48,000 | 96,000 | 5,200 | 1,125 | 58.4 | 715 | 76.6 | 0.07 |
| 68 | 114.29 | 72,000 | 144,000 | 4,800 | 1,530 | 73.4 | 984 | 96.7 | 0.07 |

NOTE:
 1) WEIGHT, WR² AND TORSIONAL STIFFNESS VALUES SHOWN ARE FOR BH HUBS AT MAXIMUM BORE SIZE.