

Double-cardanic shaft coupling (Non Sparking)

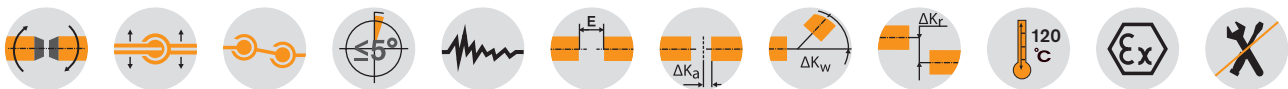

Components

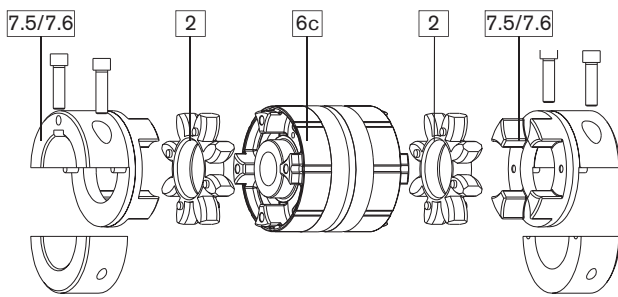
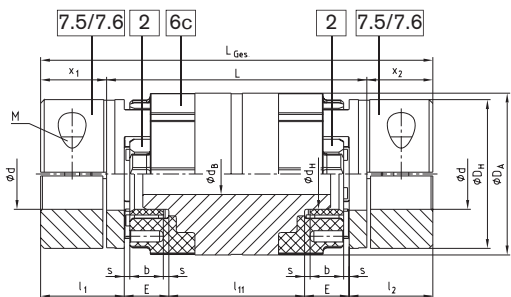

ROTEX® SP Type ZS-DKM-C (No. 085)																	
Size	Drop-out center length L	Spider (part 2) 1) Rated torque [Nm]	Dimensions [mm]													Dimensions [mm]	
			Maximum finish bore ^{2) d}	General component 7.5/7.6 steel											ROTEX® SP comp. 6c Al-H ³⁾		
				L _{Ges.}	l ₁ ; l ₂	x ₁ ; x ₂	E	b	s	D _H	D _A	d _H	M	T _A [Nm]	d _B	l ₁₁	
24	100	35	28	145	30	22,5	18	14	2,0	55	61	27	M6	14	14	49	
	140		185	89													
28	100	95	38	151	35	25,5	20	15	2,5	65	72	30	M8	35	16	41	
	140		191	81													
38	100	190	45	171	45	35,5	24	18	3,0	80	87	38	M8	35	22	33	
	140		211	73													
42	100	265	55	178	50	39	26	20	3,0	95	103	46	M10	69	30	26	
	140		218	66													
48	140	310	60	230	56	45	28	21	3,5	105	114	51	M12	120	35	62	
	140		240	50													
55	180	410	70	280	65	50	30	22	4,0	120	130	60	M12	120	35	90	
	200		300	110													
	140		260	40													
65	140	625	80	300	75	60	35	26	4,5	135	146	68	M12	120	48	40	
	180		300	50													

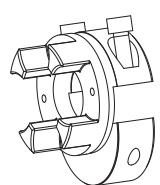

Type 7.5 clamping hub type DH without feather keyway for double-cardanic connection

Type 7.6 clamping hub type DH with feather keyway for double-cardanic connection

¹⁾ Maximum torque of coupling TK_{max.} = rated torque of coupling TK rated x 2. Transmittable torque acc. to 92 Sh-A-GS
²⁾ Hub type 7.5= without keyway; hub type 7.6=with keyway to DIN 6685 sheet 1 (J59)
³⁾ Size 42 with drop-out center length 100 made of steel
■ = Available from stock

Ordering example:	ROTEX® SP 38	ZS-DKM-C	140	98 Sh-A-GS	7.5	Ø38	7.5	Ø30
	Coupling size	Type	Drop-out center length L	Spider hardness	Hub type	Finish bore	Hub type	Finish bore