

# CLAMPEX® KTR 250

## Clamping elements

Self-centering clamping element particularly suitable for thin-walled hubs



For legend of pictogram please refer to flapper on the cover

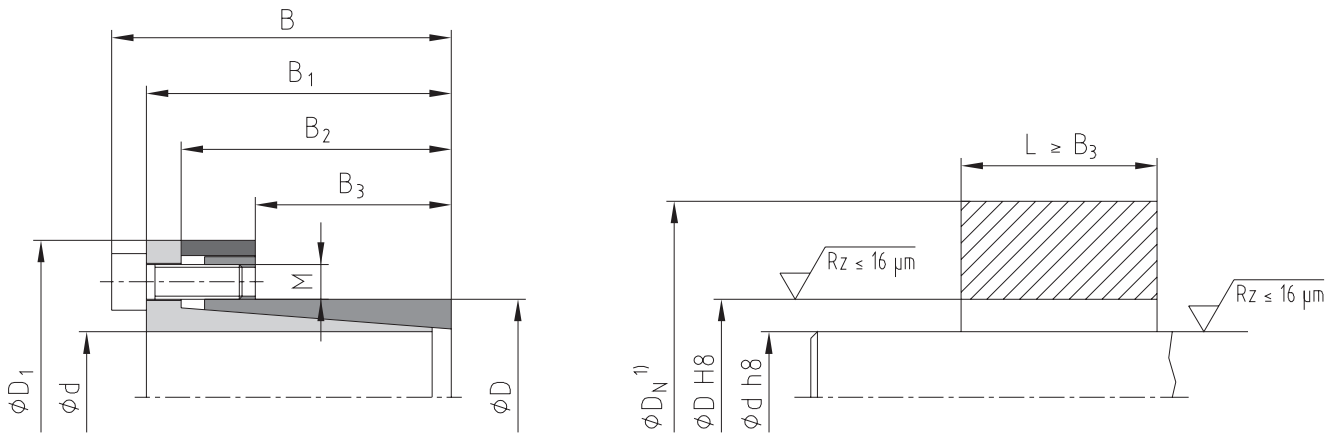

<sup>1)</sup> Dimension  $D_N$ : For calculation see page 263/264.

### Example of application of hub type

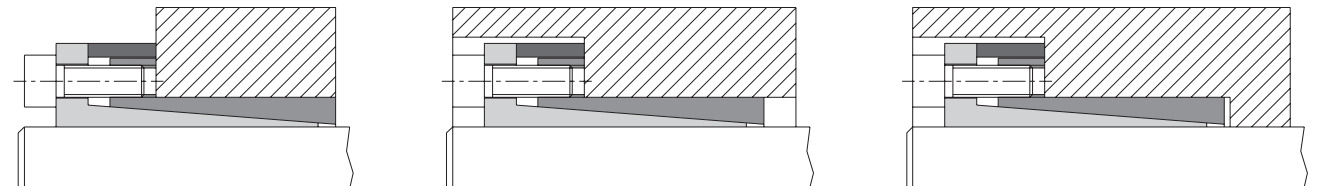

|                   |         |                           |   |                            |
|-------------------|---------|---------------------------|---|----------------------------|
| Ordering example: | KTR 250 | 28                        | x | 39                         |
|                   | Series  | Size of inside diameter d |   | Size of outside diameter D |

# CLAMPEX® KTR 250

## Clamping elements

NEW  
NEW

| CLAMPEX® – KTR 250 |                 |                |                |                |                |                                                              |        |            |                                   |                                        |                      |                                                |                                 |                 |                      |
|--------------------|-----------------|----------------|----------------|----------------|----------------|--------------------------------------------------------------|--------|------------|-----------------------------------|----------------------------------------|----------------------|------------------------------------------------|---------------------------------|-----------------|----------------------|
| d x D<br>[mm]      | Dimensions [mm] |                |                |                |                | Clamping screws DIN EN ISO 4762 - 12.9<br>$\mu_{total}=0.14$ |        |            |                                   | Transmittable torque or<br>axial force |                      | Surface pressure be-<br>tween clamping element |                                 | Weight<br>[~kg] | Stock pro-<br>gramme |
|                    | B               | B <sub>1</sub> | B <sub>2</sub> | B <sub>3</sub> | D <sub>1</sub> | M                                                            | Length | z<br>No. z | T <sub>A</sub> [Nm] <sup>1)</sup> | T [Nm]                                 | F <sub>ax</sub> [kN] | Shaft PW<br>[N/mm <sup>2</sup> ]               | Hub PN [N/<br>mm <sup>2</sup> ] |                 |                      |
| 6 x 14             | 24,5            | 21,5           | 18,5           | 10             | 25             | M3                                                           | 10     | 4          | 2,6                               | 11                                     | 4                    | 162                                            | 69                              | 0,05            | ●                    |
| 8 x 15             | 29              | 25             | 21,5           | 11,5           | 27             | M4                                                           | 10     | 3          | 5,6                               | 26                                     | 7                    | 187                                            | 100                             | 0,05            | ●                    |
| 9 x 16             | 30              | 26             | 22,5           | 14             | 28             | M4                                                           | 10     | 4          | 5,6                               | 37                                     | 8                    | 173                                            | 97                              | 0,06            | ●                    |
| 10 x 16            | 30              | 26             | 22,5           | 14             | 29             | M4                                                           | 10     | 4          | 5,6                               | 42                                     | 8                    | 159                                            | 99                              | 0,16            | ●                    |
| 11 x 18            | 30              | 26             | 22,5           | 13,5           | 32             | M4                                                           | 10     | 4          | 5,6                               | 50                                     | 9                    | 162                                            | 99                              | 0,18            | ●                    |
| 12 x 18            | 30              | 26             | 22,5           | 13,5           | 32             | M4                                                           | 10     | 4          | 5,6                               | 55                                     | 9                    | 150                                            | 100                             | 0,18            | ●                    |
| 14 x 23            | 30              | 26             | 22,5           | 14             | 38             | M4                                                           | 10     | 6          | 5,6                               | 100                                    | 14                   | 193                                            | 118                             | 0,20            | ●                    |
| 15 x 24            | 42              | 36             | 28,5           | 16             | 44             | M6                                                           | 18     | 4          | 15                                | 145                                    | 19                   | 214                                            | 134                             | 0,2             | ●                    |
| 16 x 24            | 42              | 36             | 28,5           | 16             | 44             | M6                                                           | 18     | 4          | 15                                | 155                                    | 19                   | 201                                            | 134                             | 0,3             | ●                    |
| 17 x 25            | 42              | 36             | 28,5           | 16             | 45             | M6                                                           | 18     | 4          | 15                                | 162                                    | 19                   | 186                                            | 126                             | 0,2             | ●                    |
| 17 x 26            | 44              | 38             | 31             | 18             | 47             | M6                                                           | 18     | 4          | 17                                | 180                                    | 21                   | 184                                            | 120                             | 0,2             | ●                    |
| 18 x 26            | 44              | 38             | 31             | 18             | 47             | M6                                                           | 18     | 4          | 17                                | 200                                    | 22                   | 182                                            | 126                             | 0,2             | ●                    |
| 19 x 27            | 44              | 38             | 31             | 18             | 48             | M6                                                           | 18     | 4          | 17                                | 210                                    | 22                   | 171                                            | 121                             | 0,3             | ●                    |
| 20 x 28            | 44              | 38             | 31             | 18             | 49             | M6                                                           | 18     | 4          | 17                                | 220                                    | 22                   | 162                                            | 116                             | 0,2             | ●                    |
| 22 x 32            | 51              | 45             | 38             | 25             | 54             | M6                                                           | 18     | 4          | 17                                | 250                                    | 23                   | 110                                            | 75                              | 0,3             | ●                    |
| 24 x 34            | 51              | 45             | 38             | 25             | 56             | M6                                                           | 18     | 4          | 17                                | 270                                    | 23                   | 99                                             | 70                              | 0,3             | ●                    |
| 25 x 34            | 51              | 45             | 38             | 25             | 56             | M6                                                           | 18     | 4          | 17                                | 280                                    | 22                   | 95                                             | 70                              | 0,3             | ●                    |
| 28 x 39            | 51              | 45             | 38             | 25             | 61             | M6                                                           | 18     | 6          | 17                                | 480                                    | 34                   | 130                                            | 93                              | 0,4             | ●                    |
| 30 x 41            | 51              | 45             | 38             | 25             | 62             | M6                                                           | 18     | 6          | 17                                | 510                                    | 34                   | 120                                            | 88                              | 0,4             | ●                    |
| 32 x 43            | 51              | 45             | 38             | 25             | 65             | M6                                                           | 18     | 8          | 17                                | 730                                    | 46                   | 151                                            | 113                             | 0,5             | ●                    |
| 35 x 47            | 56              | 50             | 43             | 30             | 69             | M6                                                           | 18     | 8          | 17                                | 800                                    | 46                   | 115                                            | 86                              | 0,5             | ●                    |
| 38 x 50            | 56              | 50             | 43             | 30             | 72             | M6                                                           | 18     | 8          | 17                                | 860                                    | 45                   | 105                                            | 80                              | 0,6             | ●                    |
| 40 x 53            | 56              | 50             | 43             | 30             | 75             | M6                                                           | 18     | 8          | 17                                | 900                                    | 45                   | 99                                             | 75                              | 0,6             | ●                    |
| 42 x 55            | 65              | 57             | 49             | 32             | 78             | M8                                                           | 22     | 8          | 41                                | 1800                                   | 86                   | 169                                            | 129                             | 0,9             | ●                    |
| 45 x 59            | 73              | 65             | 57             | 40             | 85             | M8                                                           | 22     | 8          | 41                                | 1900                                   | 84                   | 124                                            | 95                              | 1,0             | ●                    |
| 48 x 62            | 78              | 70             | 62             | 45             | 87             | M8                                                           | 22     | 8          | 41                                | 2000                                   | 83                   | 102                                            | 79                              | 1,0             | ●                    |
| 50 x 65            | 78              | 70             | 62             | 45             | 92             | M8                                                           | 22     | 10         | 41                                | 2600                                   | 104                  | 123                                            | 94                              | 1,3             | ●                    |
| 55 x 71            | 83              | 75             | 67             | 50             | 98             | M8                                                           | 22     | 10         | 41                                | 2900                                   | 105                  | 102                                            | 79                              | 1,5             | ●                    |
| 60 x 77            | 83              | 75             | 67             | 50             | 104            | M8                                                           | 22     | 10         | 41                                | 3100                                   | 103                  | 91                                             | 71                              | 1,7             | ●                    |
| 65 x 84            | 83              | 75             | 67             | 50             | 111            | M8                                                           | 22     | 10         | 41                                | 3400                                   | 105                  | 85                                             | 66                              | 1,9             | ●                    |
| 70 x 90            | 101             | 91             | 80             | 60             | 119            | M10                                                          | 25     | 10         | 83                                | 5800                                   | 166                  | 105                                            | 81                              | 2,9             | ●                    |
| 75 x 95            | 101             | 91             | 80             | 60             | 126            | M10                                                          | 25     | 10         | 83                                | 6200                                   | 165                  | 97                                             | 77                              | 2,3             | ●                    |
| 80 x 100           | 106             | 96             | 85             | 65             | 131            | M10                                                          | 25     | 12         | 83                                | 8000                                   | 200                  | 102                                            | 82                              | 3,3             | ●                    |
| 85 x 106           | 106             | 96             | 85             | 65             | 137            | M10                                                          | 25     | 12         | 83                                | 8500                                   | 200                  | 96                                             | 77                              | 3,6             | ●                    |
| 90 x 112           | 106             | 96             | 85             | 65             | 143            | M10                                                          | 25     | 15         | 83                                | 11200                                  | 249                  | 113                                            | 91                              | 3,9             | ●                    |
| 95 x 120           | 106             | 96             | 85             | 65             | 153            | M10                                                          | 25     | 15         | 83                                | 11800                                  | 248                  | 107                                            | 84                              | 4,5             | ●                    |
| 100 x 125          | 114             | 102            | 89             | 65             | 162            | M12                                                          | 30     | 12         | 145                               | 14600                                  | 292                  | 119                                            | 95                              | 5,5             | ●                    |
| 110 x 140          | 140             | 128            | 114            | 90             | 180            | M12                                                          | 30     | 12         | 145                               | 16000                                  | 291                  | 78                                             | 61                              | 8,0             | ●                    |
| 120 x 155          | 140             | 128            | 114            | 90             | 198            | M12                                                          | 30     | 12         | 145                               | 17400                                  | 290                  | 71                                             | 55                              | 10,5            | ●                    |
| 130 x 165          | 140             | 128            | 114            | 90             | 208            | M12                                                          | 30     | 16         | 145                               | 25000                                  | 385                  | 87                                             | 69                              | 11,9            | ●                    |

● Sizes of clamping elements available from stock.

<sup>1)</sup> These are the maximum screw tightening torques. They can be reduced by a maximum of 40 % of the above-mentioned figures with T, F<sub>ax</sub>, P<sub>W</sub> and P<sub>N</sub> decreasing proportionately.