

CLAMPEX® KTR 225

Clamping elements

Self-centering, combination of a hub \varnothing with various shaft \varnothing



For legend of pictogram please refer to flapper on the cover

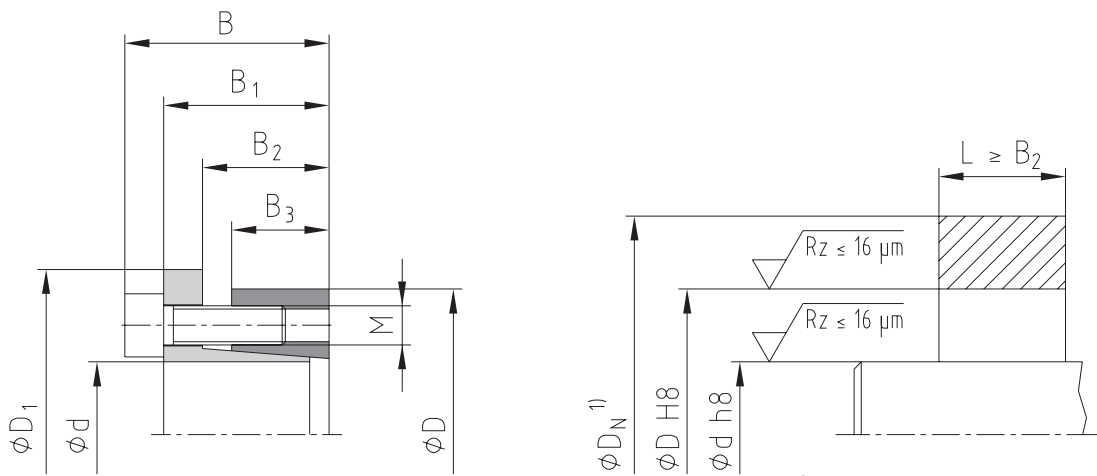
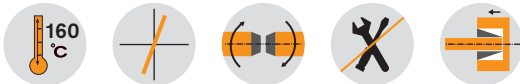

¹⁾ Dimension D_N : For calculation see page 263/264.

Example of application of hub type

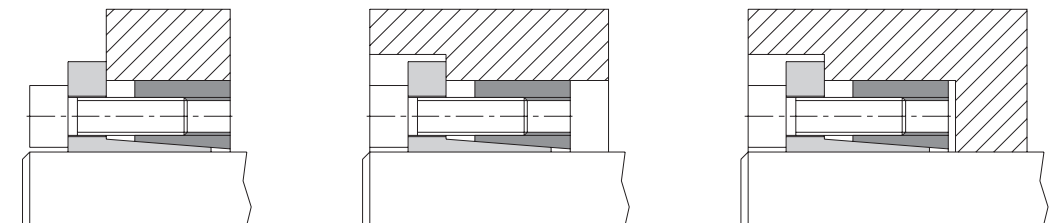

To fasten one size of hub on different shaft diameters

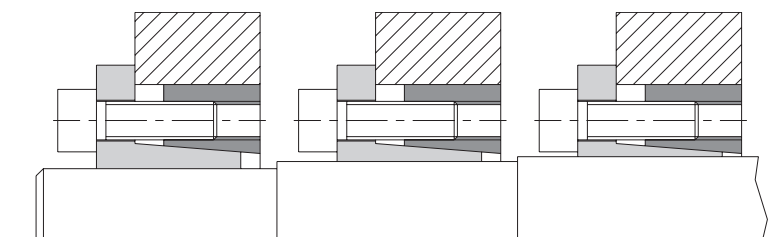

Ordering example:	KTR 225	28	x	65
	Series	Size of inside diameter d		Size of outside diameter D

CLAMPEX® – KTR 225																
d x D [mm]	Dimensions [mm]					Clamping screws DIN EN ISO 4762 - 12.9 $\mu_{total}=0.14$				Transmittable torque or axial force			Surface pressure between clamping element		Weight [-kg]	Stock programme
	B	B ₁	B ₂	B ₃	D ₁	M	Length	Number z	T _A ¹⁾ [Nm]	T [Nm]	F _{ax} [kN]	Shaft PW [N/mm ²]	Hub PN [N/mm ²]			
14 x 55	38	30	22	17	62	M8	25	4	41	287	41	457	116	0,5		
16 x 55	38	30	22	17	62	M8	25	4	41	329	41	401	117	0,5	●	
18 x 55	38	30	22	17	62	M8	25	4	41	370	41	356	117	0,5	●	
19 x 55	38	30	22	17	62	M8	25	4	41	390	41	337	116	0,5	●	
20 x 55	38	30	22	17	62	M8	25	4	41	410	41	320	116	0,5	●	
22 x 55	38	30	22	17	62	M8	25	4	41	451	41	291	116	0,5	●	
24 x 55	38	30	22	17	62	M8	25	4	41	492	41	267	116	0,4	●	
25 x 55	38	30	22	17	62	M8	25	4	41	513	41	256	116	0,4	●	
28 x 55	38	30	22	17	62	M8	25	4	41	575	41	229	117	0,4	●	
30 x 55	38	30	22	17	62	M8	25	4	41	616	41	214	117	0,4	●	
24 x 65	38	30	22	17	72	M8	25	5	41	616	51	334	123	0,7	●	
25 x 65	38	30	22	17	72	M8	25	5	41	641	51	320	123	0,7	●	
28 x 65	38	30	22	17	72	M8	25	5	41	718	51	286	123	0,6	●	
30 x 65	38	30	22	17	72	M8	25	5	41	770	51	267	123	0,6	●	
32 x 65	38	30	22	17	72	M8	25	5	41	821	51	250	123	0,6	●	
35 x 65	38	30	22	17	72	M8	25	5	41	898	51	229	123	0,5	●	
38 x 65	38	30	22	17	72	M8	25	5	41	975	51	211	123	0,5	●	
40 x 65	38	30	22	17	72	M8	25	5	41	1026	51	200	123	0,5	●	
30 x 80	41	33	25	20	88	M8	25	7	41	1077	72	317	119	1,1		
32 x 80	41	33	25	20	88	M8	25	7	41	1150	72	298	119	1,1		
35 x 80	41	33	25	20	88	M8	25	7	41	1257	72	272	119	1,0		
38 x 80	41	33	25	20	88	M8	25	7	41	1364	72	251	119	1,0		
40 x 80	41	33	25	20	88	M8	25	7	41	1436	72	238	119	0,9	●	
42 x 80	41	33	25	20	88	M8	25	7	41	1509	72	227	119	0,9		
45 x 80	41	33	25	20	88	M8	25	7	41	1616	72	212	119	0,9		
48 x 80	41	33	25	20	88	M8	25	7	41	1723	72	198	119	0,8		
50 x 80	41	33	25	20	88	M8	25	7	41	1796	72	191	119	0,8	●	

● Sizes of clamping elements available from stock.

¹⁾ These are the maximum screw tightening torques. They can be reduced by a maximum of 40 % of the above-mentioned figures with T, F_{ax}, P_W and P_N decreasing proportionately.