

Split CFK sleeve for high power density

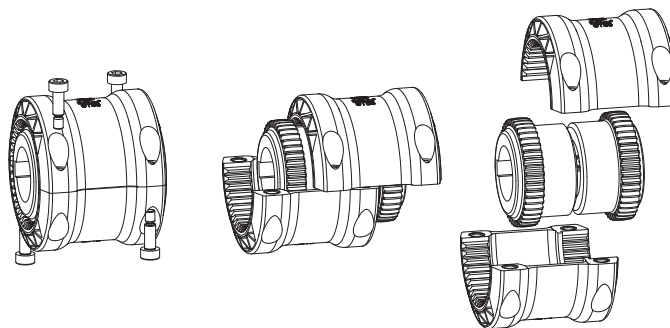
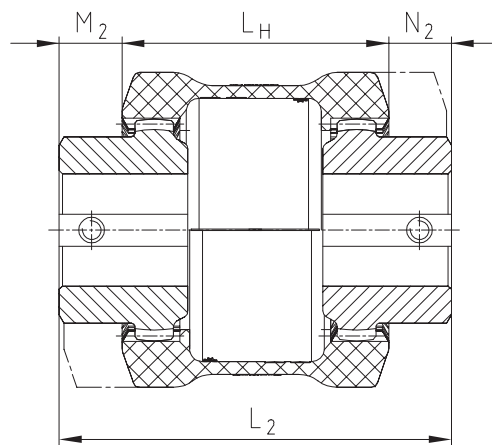
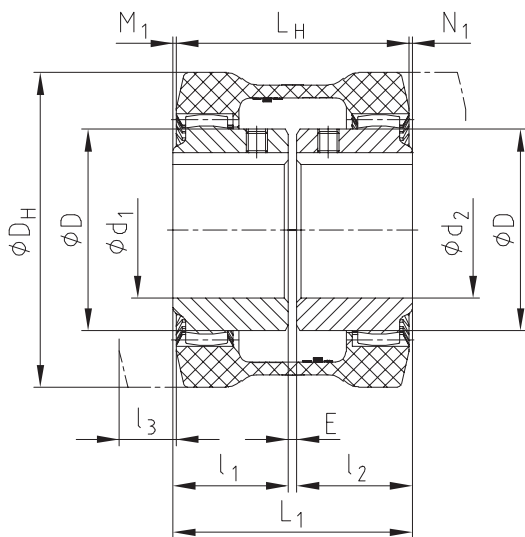
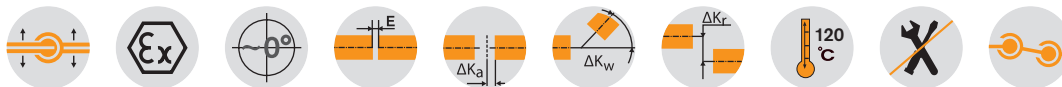

BoWex® type GT with split sleeve

Size	Finish bore d_{max}		Dimensions [mm]										Weight with max. bore \emptyset			Mass moment of inertia J with max. bore \emptyset			
	d_1	d_2	D	D_H	L_H	l_1	l_2	l_3	E	L_1	L_2	M_1, N_1	M_2, N_2	Sleeve [kg]	Hub [kg]	Total [kg]	Sleeve [kgcm ²]	Hub [kgcm ²]	Total [kgcm ²]
28	28	28	44	80	80	40	40	15	4	84	124	2	22	0,158	0,22	0,702	1,77	1,22	4,21
38	38	38	58	98	83	40	40	18	4	84	122	0,5	19,5	0,25	0,45	1,15	4,43	3,36	11,15
48	48	48	68	110	106	50	50	21	4	104	160	0	28	0,33	0,67	1,68	7,39	6,11	19,61
65	65	65	96	150	111	55	55	27	4	114	160	1,5	24,5	0,69	1,54	3,77	28,9	31,80	92,5

l_3 Drop-out center dimension required

Ordering example:

BoWex® GT-28	d_1 Ø20	d_2 Ø28
Size and type of coupling	Finish bore H7 keyway to DIN 6885 sheet 1 (JS9)	Finish bore H7 keyway to DIN 6885 sheet 1 (JS9)