

Classic Sprockets

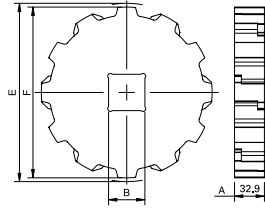

| Type | Code Number | Number of Teeth | Bore | Pitch Diameter | Outside Diameter | Hub Width |
|------|-------------|-----------------|---------|----------------|------------------|-----------|
| | | | B | E | F | A |
| | | | mm/inch | mm | mm | mm |

Classic Sprockets

Square Bores

| Type | Code Number | Number of Teeth | Bore | Pitch Diameter | Outside Diameter | Hub Width |
|------------------|-------------|-----------------|------|----------------|------------------|-----------|
| CS 2010-6-40x40 | 897.20.23 | 6* | 40 | 101.6 | 87.0 | 33 |
| CS 2010-8-40x40 | 897.20.04 | 8 | 40 | 132.8 | 121.0 | |
| CS 2010-10-40x40 | 897.20.07 | 10 | 40 | 164.4 | 154.0 | |
| CS 2010-10-60x60 | 897.20.10 | 10 | 60 | | | |
| CS 2010-12-40x40 | 897.20.26 | 12 | 40 | 196.3 | 188.0 | |
| CS 2010-12-60x60 | 897.20.29 | 12 | 60 | | | |

* 6 teeth sprockets are not recommended as drive sprockets.

Accessory Information:



Straight Flight for 2010-Series

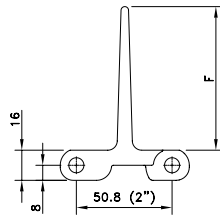

Curved Ribbed Flight for 2010-Series

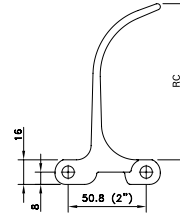

Sideguards for 2010-Series

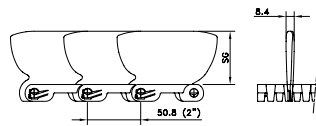

Bucket Flight for 2010-Series

