

## Part. S0846

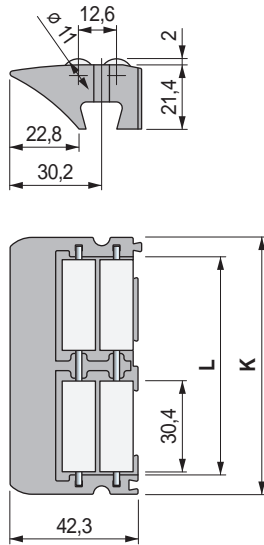

**NEW**

### End transfer module (with lip)



K mm	L mm	Code	Weight kg
85	72	<b>645573</b>	0,046
115	102	<b>645583</b>	0,063

- Material: frame in acetal Rex-HP™ (dark grey) very low coefficient of friction, rollers in acetal POM (white). Roller pins in austenitic stainless steel.
- Modularity: snap-on assembly with Part. S0847 - S0848 - S0849.
- Packaging: 10 pieces.

## Part. S0847



**NEW**

### End transfer module (with lip)

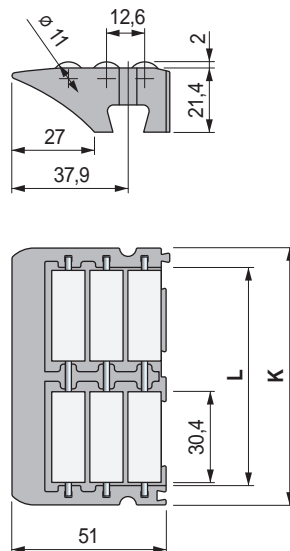

K mm	L mm	Code	Weight kg
85	72	<b>645593</b>	0,062
115	102	<b>645603</b>	0,085

- Material: frame in acetal Rex-HP™ (dark grey) very low coefficient of friction, rollers in acetal POM (white). Roller pins in austenitic stainless steel.
- Modularity: snap-on assembly with Part. S0846 - S0848 - S0849.
- Packaging: 10 pieces.

### • Assembly Part. S0846 - S0846

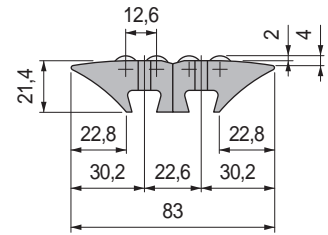

### • Assembly Part. S0846 - S0847

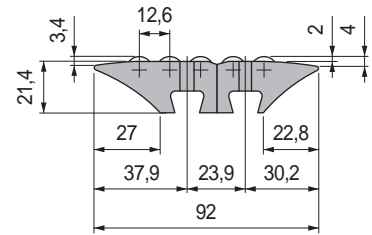

### • Assembly Part. S0846 - S0848

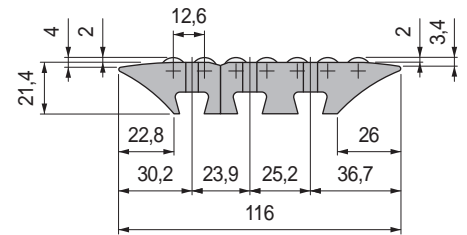

### • Assembly Part. S0846 - S0849

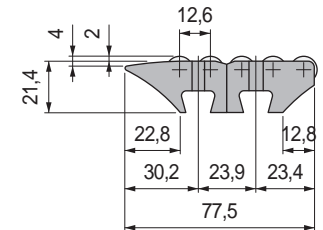

### • Assembly Part. S0847 - S0847

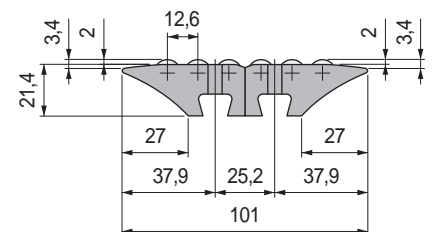

● Best Seller

● Standard

● On request: minimum quantity may apply. Consult our Customer Service for availability.

Item code for order = Part. + Code