

- **Material:** Polyethylene UHMWPE with molecular density 5.600.000 g/mol.
Characteristics: new material Polyethylene ULF brown red (UHMWPE): reduced friction coefficient, higher wear resistance.
- **Operating temperature White, Green, Black:**
In air (- 40 to + 80 °C).
In hot water (+ 70 °C).
- **Operating temperature ULF - brown red:**
In air (- 40 to + 45 °C).
In hot water (+ 45 °C).
- **Polyethylene ULF is FDA approved**
Polyethylene ULF complies with the Code of Federal Regulations Title 21, § 177.1520 "Olefin Polymers" of the Food and Drug Administration (FDA) of April 1, 2008.

- **Use of Part. S0770 - S0769** Medium strength containers. (ex. latten, glass)

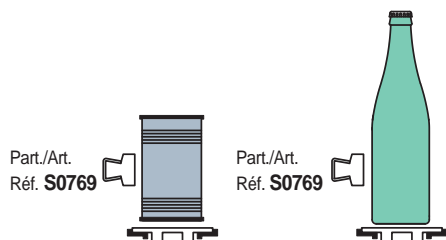

■ Guide rail (flat)

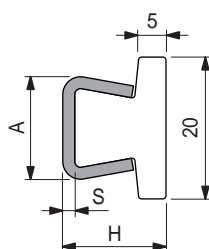

S	H	A
mm	mm	mm
1,5	17	16
2	17,5	17

Part. S0770



Thickness	S	Metal profile material	Length metres	Code	Weight kg/m
mm	mm				
1,5		Austenitic stainless steel	3	609183N	0,61
			6	609193N	
2		Austenitic stainless steel	3	609203N	0,71
			6	609213N	

- Colour: white.
- Antistatic polyethylene UHMWPE (black) available upon request with minimum quantities.
- Min. curvature radius: 160 mm.
- Linear expansion coefficient: $4 \times 10^{-5} \text{ } ^\circ\text{C}^{-1}$.
- Calculation of thermal expansion see Technical information.
- Packaging: 24 metres.
- Accessories:



Guide - Rail Clamps.



Guide rail bending machine (manual)
Part. S0218.

■ Guide rail (flat)

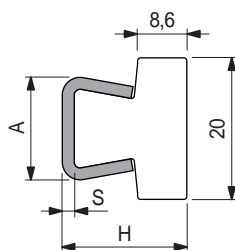

S	H	A
mm	mm	mm
1,5	20,5	16
2	21	17

Part. S0769



Thickness	S	Metal profile material	Length metres	Code	Weight kg/m
mm	mm				
1,5		Austenitic stainless steel	3	609133N	0,67
			6	609143N	
2		Austenitic stainless steel	3	609163N	0,78
			6	609173N	

- Colour: white.
- Antistatic polyethylene UHMWPE (black) available upon request with minimum quantities.
- Min. curvature radius: 160 mm.
- Linear expansion coefficient: $4 \times 10^{-5} \text{ } ^\circ\text{C}^{-1}$.
- Calculation of thermal expansion see Technical information.
- Packaging: 24 metres.
- Accessories:



Guide - Rail Clamps.



Guide rail bending machine (manual)
Part. S0218.

● **Best Seller**

● **Standard**

● **On request:** minimum quantity may apply. Consult our Customer Service for availability.

Item code for order = Part. + Code