

## Part. S0678

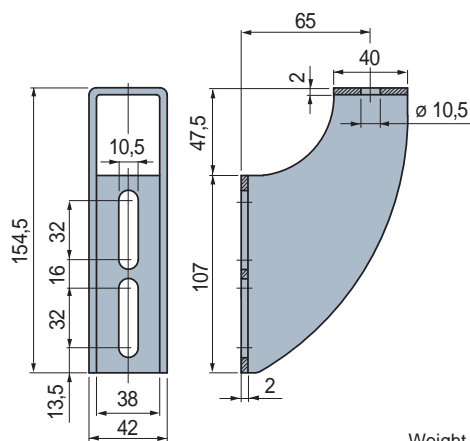

### Adjustable bracket



Code	Weight kg
<b>684292</b>	0,32

- Material: austenitic stainless steel.
- Packaging: 6 pieces.

## Part. S0679



### Adjustable bracket

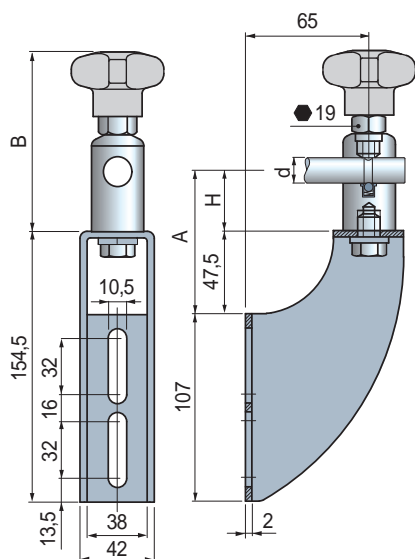

Pin dia. d mm	A mm	H mm	Code	B mm	Weight kg
<b>Without positioner</b>					
70	22,5		<b>684302</b>	89	0,60
87,5	40		<b>684312</b>	106,5	0,70
14÷16	107,5	60	<b>684322</b>	126,5	0,81
	137,5	90	<b>684332</b>	156,5	0,97
	177,5	130	<b>684342</b>	196,5	1,20
<b>With positioner</b>					
	87,5	40	<b>685072</b>	106,5	0,70
16*	107,5	60	<b>685082</b>	126,5	0,81
	137,5	90	<b>685092</b>	156,5	0,97
	177,5	130	<b>685102</b>	196,5	1,20

- \* = Version with positioner can be used only with dia. 16 mm pins.
- Material: bracket in austenitic stainless steel.
- Swivel head in austenitic stainless steel.
- Knob in reinforced polypropylene PP FV (grey).
- Hexagonal insert (for 19 mm wrench) and bolts in austenitic stainless steel.
- Max recommended tightening torque: 4 Kgm.
- Packaging: 6 pieces.

● Best Seller

● Standard

● On request: minimum quantity may apply. Consult our Customer Service for availability.

Item code for order = Part. + Code

### Assembly of Part. S0678

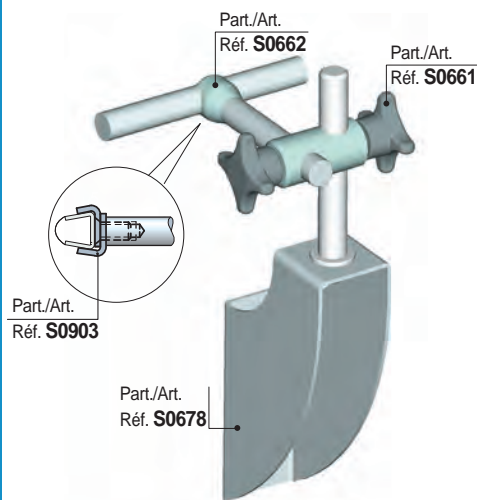

### Accessories for Part. S0678

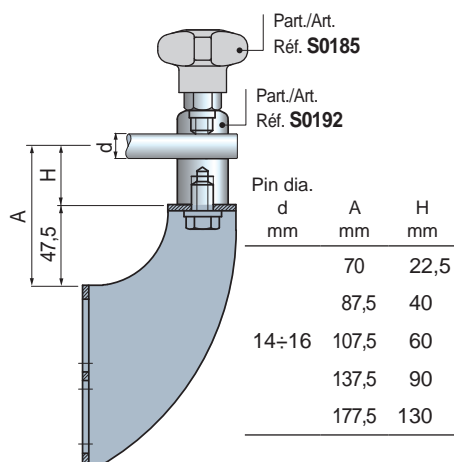

### Assembly of Part. S0679

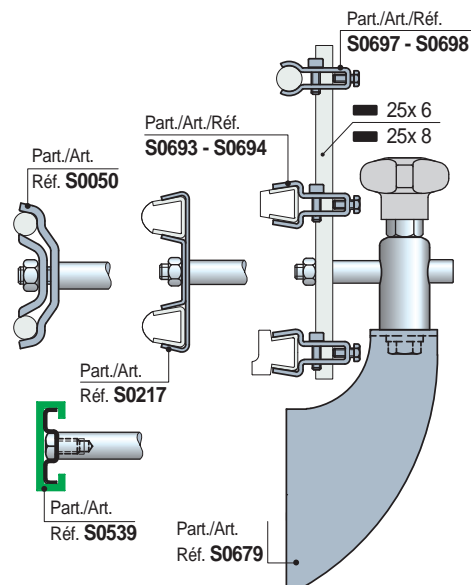

### Pin dimension for positioner

