

• **Example of application** of version with hexagonal seat

**Use with nut**

Apply a standard hexagonal M 8 UNI 5588, DIN 934.

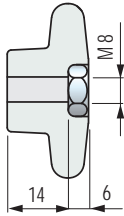

**Use with screw**

Apply an hexagonal head screw M 8 UNI 5739, DIN 933, ISO 4017.

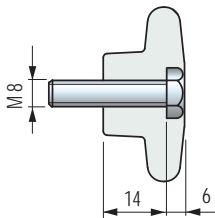

**Use with nut**

Apply a standard hexagonal M 10 UNI 5588, DIN 934.

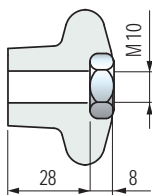

**Use with screw**

Apply an hexagonal head screw M 10 UNI 5739, DIN 933, ISO 4017.

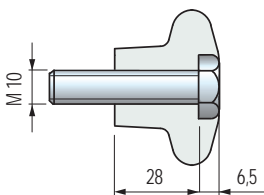

■ **Tightening knob**

**Version with threaded insert**

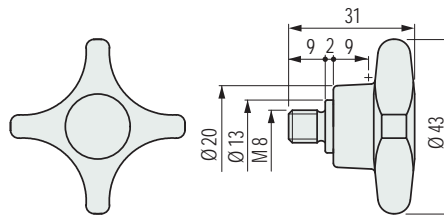

**Version with hexagonal seat**

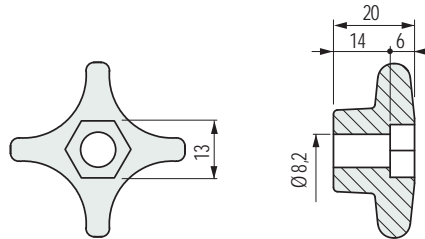

Version

Code

With threaded insert	676392
With hexagonal seat	676402

- Supplied in reinforced Polypropylene PP FV, gives a better resistance to chemical agents.
- Material: knob in reinforced Polypropylene PP FV (grey), threaded insert in austenitic stainless steel.
- Max admitted tightening torque: 1 Kgm (version with threaded insert).
- Packaging: 50 pieces.

■ **Tightening knob**

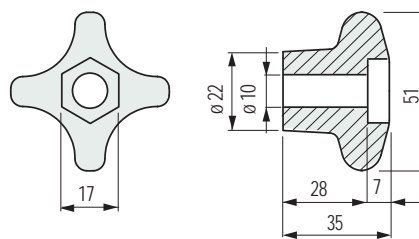

Code

Weight  
kg

**Reinforced Polyamide PA FV (black)**

693552 0,02

**Reinforced Polypropylene PP FV (grey)**

693562 0,02

- Economical version (supplied without tightening elements).
- The version in reinforced Polypropylene PP FV, gives a better resistance to chemical agents.
- Packaging: 50 pieces.

Part. S0671



Part. S0734



- **Best Seller**
- **Standard**
- **On request:** minimum quantity may apply. Consult our Customer Service for availability.

Item code for order = Part. + Code