

## Part. S0642

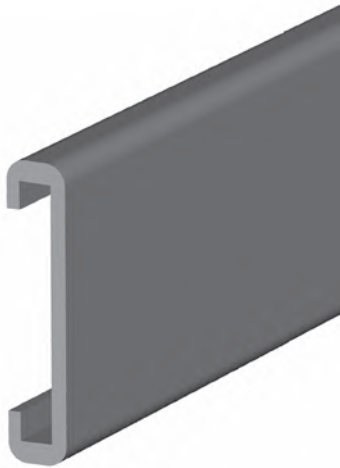

### ■ Guide rail (extra flat)

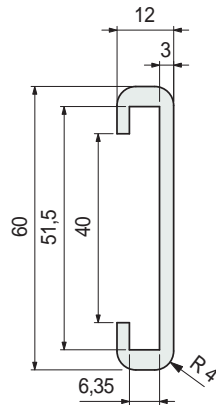

Material	Length metres	Code
UHMWPE		
Black	3	<b>652292</b>

- Linear expansion coefficient:  $2 \times 10^{-4} \text{ } ^\circ\text{C}^{-1}$ . Calculation of thermal expansion see Technical information.
- Packaging: 36 metres.
- Accessories:



Metal profile  
Part. S0643.

## Part. S0643



### ■ Metal profile

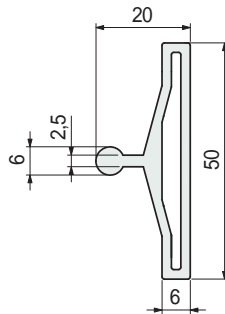

Metal profile material	Length metres	Code
Anodized aluminium	3	<b>652302</b>
	6	<b>652312</b>

- Can be used in combination with Part. S0642.
- Packaging: 36 metres.
- Accessories:



Guide - Rail  
Clamps.

### • Use of Part. S0642 - S0643

Rugged containers with delicate surface (for example decorated glass bottles). Can be used in combination with Part. S0605.

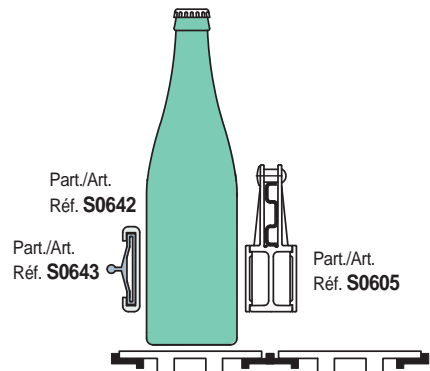

● Best Seller

● Standard

● On request: minimum quantity may apply. Consult our Customer Service for availability.

Item code for order = Part. + Code