

Part. S0565

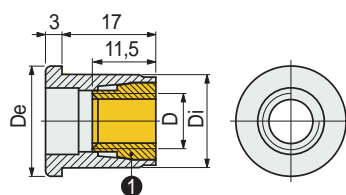

Expansion plugs



Tube dimensions ① Expansion cone

Outside mm	Thickness mm	Inside mm	Thread D	De mm	Di mm	Code
Ø 18	1,5	15	M8	18	15	698661
	2	14	M6	18	14	698671
Ø 20	1,5	17	M8	20	17	698681
			M10	20	17	698691

- Material: plug in polyamide PA (black), expansion cone in brass.
- Standard packaging: expansion cone is supplied separated from the plug.
- Weight: 0,01Kg.
- Packaging: 100 pieces.
- Max recommended tightening torque: 1 Kgm.

Part. S0179



Expansion plugs

Expansion cone
in brass

Expansion cone in reinforced
polyamide PA FV

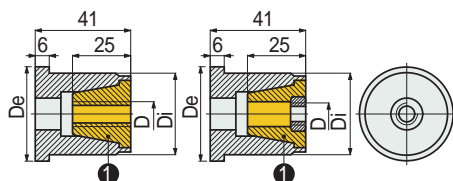

Tube dimensions ① Expansion cone

Outside mm	Thickness mm	Inside mm	Thread D	De mm	Di mm	Code
---------------	-----------------	--------------	-------------	----------	----------	------

• Expansion cone in brass

Ø 38	1,5	35	M8	40	34,8	69513
			M10	40	34,8	69523
Ø 42,4	1,5	39,4	M8	44,5	39,2	69533
			M10	44,5	39,2	69543

• Expansion cone in reinforced polyamide PA FV

Ø 38	1,5	35	M8	20	34,8	54881
			M10	20	34,8	52641
Ø 42,4	1,5	39,4	M8	20	39,2	54891
			M10	20	39,2	52651

- Material: plug in reinforced polyamide PA FV (black), expansion cone in brass or in reinforced polyamide PA FV.
- Weight: 0,10 Kg.
- Packaging: 50 pieces.
- Max recommended tightening torque: 2,5 Kgm (for M8), 4 Kgm (for M10).

• Deflection of Part. S0179

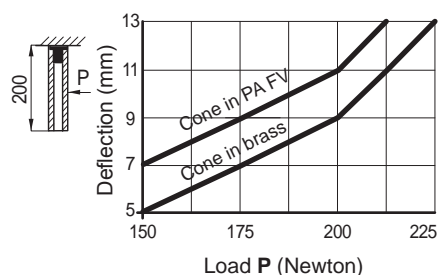

● Best Seller

● Standard

● On request: minimum quantity may apply. Consult our Customer Service for availability.

Item code for order = Part. + Code

• Assembly Part. S0565 - S0179

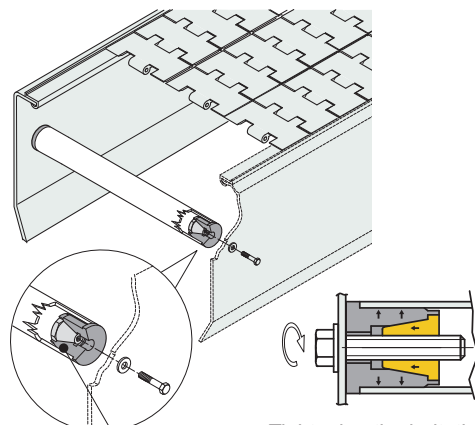

Part./Art.
Réf. S0565 - S0179

Tightening the bolt, the plug expands and stays firmly in the tube.

• Application example of Part. S0565 for return chain rollers

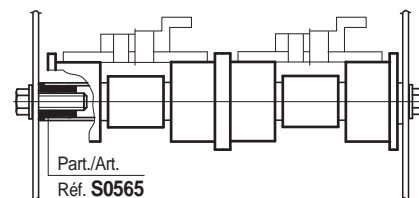

Part./Art.
Réf. S0565

• Application example of Part. S0565 for serpentine return

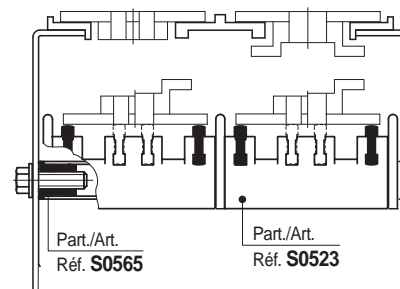

Part./Art.
Réf. S0565

Part./Art.
Réf. S0523

• Application example of Part. S0179 for supporting chain guide profile Part. S0366 - S0367 - S0368

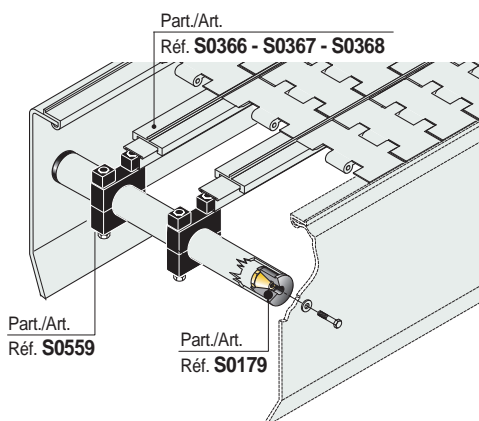

Part./Art.
Réf. S0559

Part./Art.
Réf. S0179

Part./Art.
Réf. S0366 - S0367 - S0368