

S0296

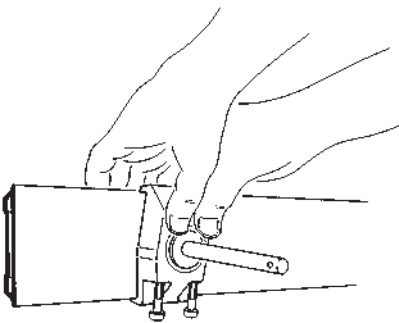

• Assembly of Part. S0298

- 1) Untighten the screws
- 2) Clip on to the profile
- 3) Slide along the guide to the desired position and tighten screws to lock in place.



■ Guide-rail clamp

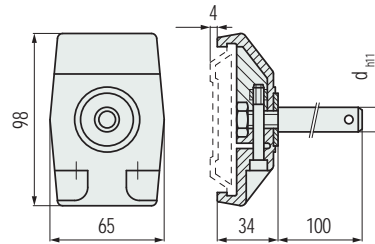

Pin dia. d mm	Code	Weight kg
12	60372	0,12
14	60382	0,25
16	60392	0,29

- Material: guide rail clamp in reinforced polyamide PA FV (black). Pin in austenitic stainless steel. Washer in austenitic stainless steel. Nut in nickel plated brass.
- Packaging: 50 pieces.
- Suitable to use in curves also.

■ Guide-rail clamp

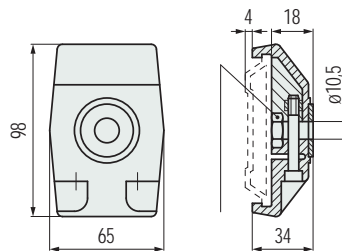

Code	Weight kg
60362	0,12

- Material: guide rail clamp in reinforced polyamide PA FV (black). Washer in austenitic stainless steel. Nut in nickel plated brass.
- Packaging: 50 pieces.
- Suitable to use in curves also.

■ Rod for Part. S0298

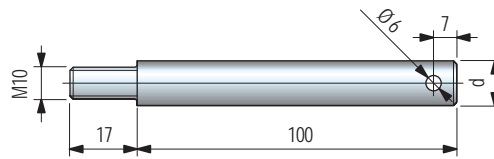

Pin dia. d mm	Code	Weight kg
12	65794	0,11
14	66004	0,14
16	66654	0,18

- Material: austenitic stainless steel.
- Packaging: 50 pieces.

Guide - Rail Clamps for
• Part. S0296

Part. S0298



Part. S0298



Part. S0000



- Best Seller
- Standard
- On request: minimum quantity may apply. Consult our Customer Service for availability.

Item code for order = Part. + Code