

## Part. S0050

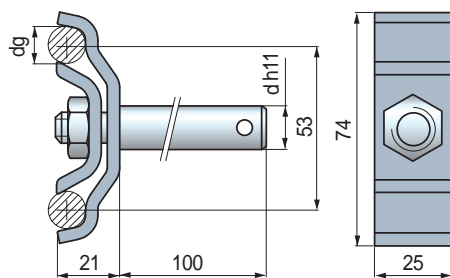

### Double guide-rail clamp



Guide dia. dg mm	pin dia. d mm	Code	Weight kg
12	12	53801	0,34
	14	51000	0,36
	16	647871	0,38

- Material: guide rail clamp and tightening nut in austenitic stainless steel. Pin in austenitic stainless steel.
- Packaging: 50 pieces.

## Part. S0676



### Joint clamp

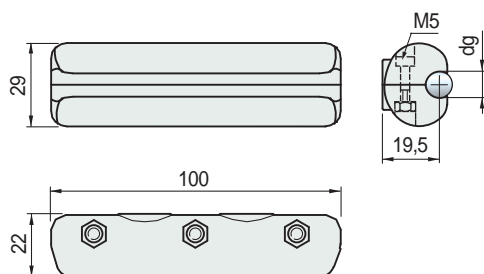

Guide dia. dg mm	Code	Weight kg
10	689682	0,10
12	689692	

- Material: joint clamp in reinforced Polyamide PA FV (black). Bolts in austenitic stainless steel. Nuts in nickel plated brass.
- Packaging: 10 pieces.

### Assembly of Part. S0050

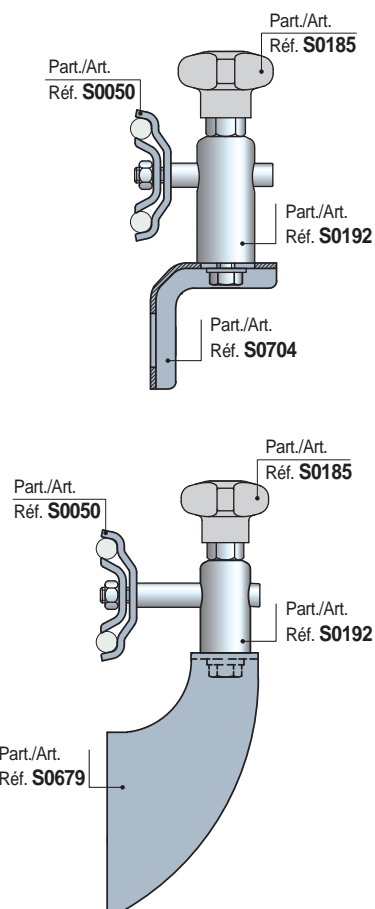

- Use of Part. S0676  
New split joint clamp, to be used for the junction of dia. 10 - 12 round guides.

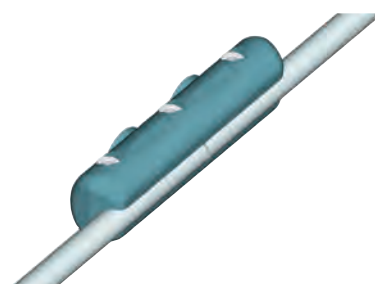

● Best Seller

● Standard

● On request: minimum quantity may apply. Consult our Customer Service for availability.

Item code for order = Part. + Code