

# 1713 K

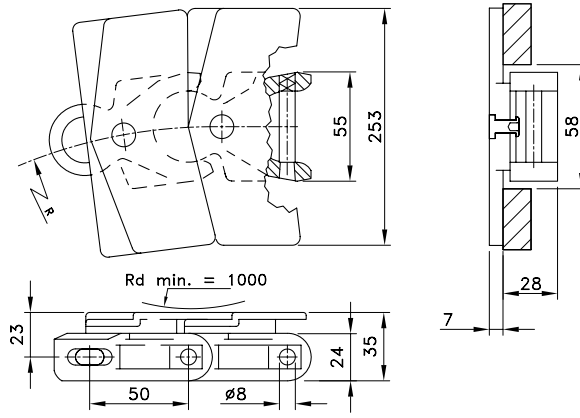

Chain Type	Code Number	Link Width		Weight	Working Load (max.)	Backflex Radius (min)	Sideflex Radius (min)
		A					
		mm	inch	kg/m	N (21°C)	mm	mm
<b>WLF-Acetal</b>							
WLF 1713 K	L1713WLFK	253.0	9.96	2.70	2600	1000	500

Standard length: 10 m - 32.8 feet (200 links). Top plate white acetal.

# 1713 TAB K

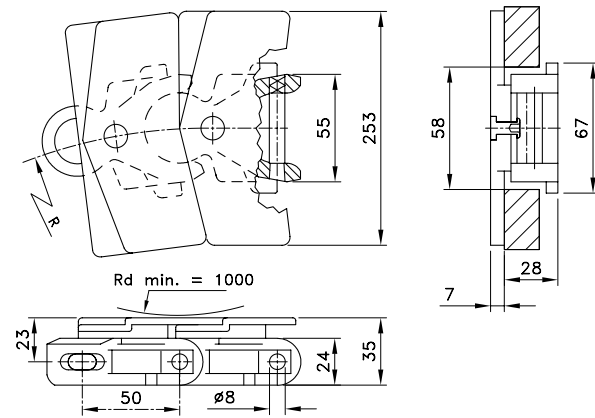
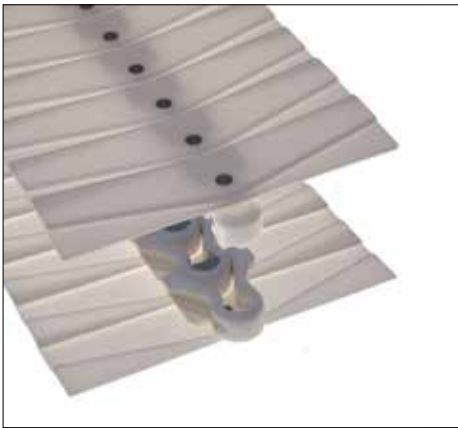

Chain Type	Code Number	Link Width		Weight	Working Load (max.)	Backflex Radius (min)	Sideflex Radius (min)
		A					
		mm	inch	kg/m	N (21°C)	mm	mm
<b>WLF-Acetal</b>							
WLF 1713 TAB K	L1713WLF TABK	253.0	9.96	2.75	2600	1000	500

Standard length: 10 m - 32.8 feet (200 links). Top plate white acetal.

## N 1700

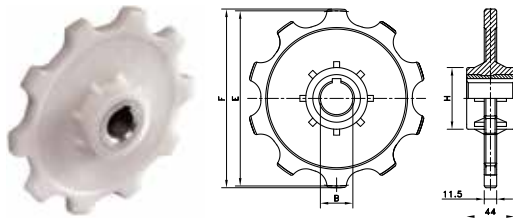

## NX 1700

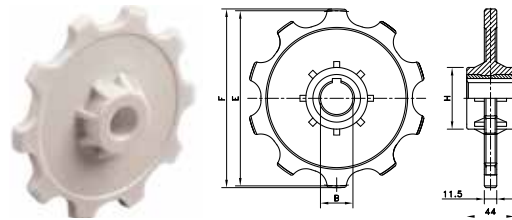

Sprocket Type	Code Number	Number of Teeth	Bore	Pitch Diameter	Outside Diameter	Width (Teeth Ring)	Hub Width	Hub Diameter
			B	E	F		H	
			mm	mm	mm	mm	mm	mm

### N 1700 - Classic Plastic Sprockets, Injection Moulded, Brass Hub

Metric Bores								
N1700 10-24	L1700661391	10	24	161.8	165.1	11.1	44.0	57
N1700 10-25	L1700661381	10	25					
N1700 10-30	L1700661401	10	30					

For Multiflex chain series: 1700, 1702, 1710, 1713, 1720, 1765.

### NX 1700 - Classic Plastic Idler, Injection Moulded

Metric Bores								
NX1700 10-25	L1700661411	10	25	161.8	165.1	11.1	43.0	50

For Multiflex chain series: 1700, 1702, 1710, 1713, 1720, 1765.

## KU 1700

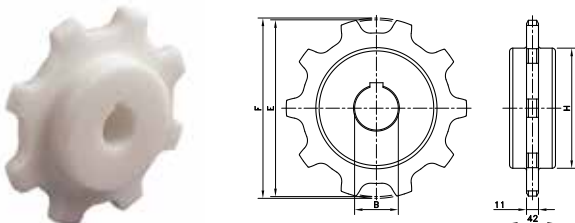

## KU 1775

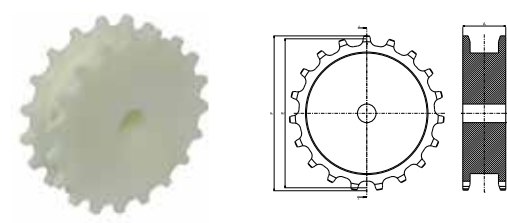

### KU 1700 - Classic Plastic Sprockets, Machined

Metric Bores								
KU1700 08-19	L1700668341	8	19	130.7	132.8	11.1	42.0	79
KU1700 08-25	L1700613242	8	25					
KU1700 08-30	L1700630842	8	30					
KU1700 10-19	L1700668351	10	19	161.8	165.1	11.1	42.0	110
KU1700 10-25	L1700602806	10	25					
KU1700 10-30	L1700618392	10	30					
KU1700 13-19	L1700668361	13	19	209.0	215.2	11.1	42.0	158

For Multiflex chain series: 1700, 1702, 1710, 1713, 1720, 1765

### KU 1775 - Classic Plastic Sprockets, Machined

Metric Bores								
KU1775 19-19	L1775635523	19	25	151,9	157,9	7.4	43.8	112.9

For Multiflex chain series: 1775.

## ZN 1700

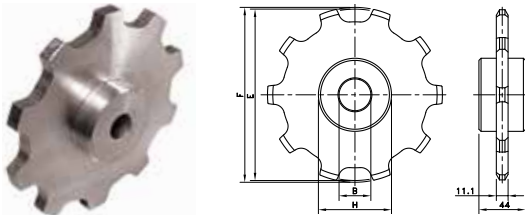

## GG1757

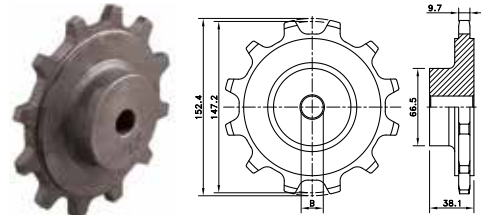

Sprocket Type	Code Number	Number of Teeth	Bore	Pitch Diameter	Outside Diameter	Width (Teeth Ring)	Hub Width	Hub Diameter
			B	E	F			
Classic Zinc Plated Steel Idlers - ZN 1700								
Metric Bores								

ZN1700 10-20	L1700661421	10	20	161.8	165.1	11.1	44.0	69.0
ZN1700 12-20	L1700661431	12	20	193.2	196.1			

For Multiflex chain series: 1700, 1702, 1710, 1713, 1720, 1765.

### Classic Semi-Steel Sprocket, Excentered Hub - GG 1757

#### Inch Bores

GG1757 12- 3/4 prebore	414-36-2	12	0.750"	147.2	152.4	9.7	38.1	66.5
------------------------	----------	----	--------	-------	-------	-----	------	------

For Multiflex chain series: 1757

## NXT 1757

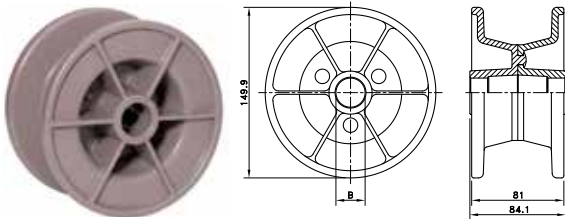

## KUS 2500

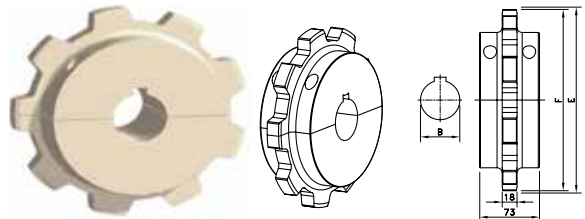

### Classic Plastic Idler Drum, Injection Moulded - NXT 1757

#### Metric Bores

NXT1757 10-25	614-25-1	10	25	-	149.9	81	84.1	38.1
---------------	----------	----	----	---	-------	----	------	------

For Multiflex chain series: 1757.

### Split Plastic Sprockets, Injection Moulded – KUS 2500

#### Metric Bores

KUS 2500 T09 R50	614-681-8	9	50	222.8	221.2	18.0	73.0	165.0
------------------	-----------	---	----	-------	-------	------	------	-------

For Multiflex chain series: 2565.

## KUS 1775

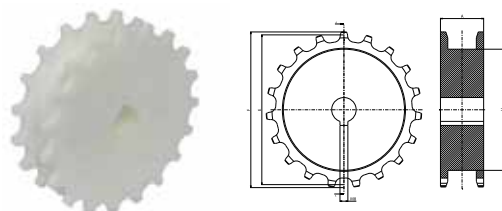

## KUS 1780

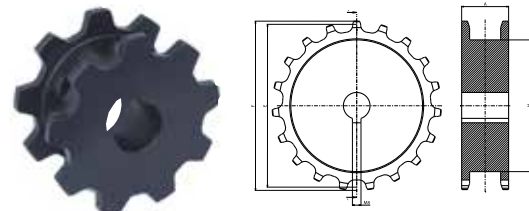

### Split Plastic Sprockets, Machined – KUS 1755

#### Metric Bores

KUS1775 19-25	L1775611316	19	25	151,9	157,9	7.4	43.8	112.9
---------------	-------------	----	----	-------	-------	-----	------	-------

For Multiflex chain series: 1775

### Split Plastic Sprockets, Machined – KUS 1780

#### Metric Bores

KUS1780 09-40	L1780609826	9	40	140.34	146	9	70	-
---------------	-------------	---	----	--------	-----	---	----	---

For Multiflex chain series: 1785.

# KTU 500 For Multiflex Chains

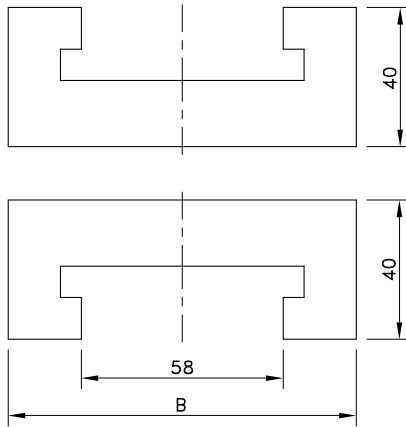

Number of Tracks	1	Basic Width B
		mm

### Version KTU 508

Width W	250 mm	500 mm	For 1700 TAB K
15°	787.12.79	787.12.89	100
30°	787.12.80	787.04.35	
45°	787.12.81	787.12.90	
60°	787.12.82	787.12.91	
75°	787.12.83	787.12.92	
90°	787.03.31	787.01.81	

### Version KTU 515

Width W	250 mm	500 mm	For 1710 TAB K
15°	787.12.84	787.12.93	110
30°	787.12.85	787.12.94	
45°	787.12.86	787.12.95	
60°	787.12.87	787.12.96	
75°	787.12.88	787.12.97	
90°	787.02.97	787.00.40	

### Version KTU 540

Width W	500 mm	For 1713 TAB K
15°	787.12.98	270
30°	787.12.99	
45°	787.13.00	
60°	787.13.01	
75°	787.13.02	
90°	787.03.63	

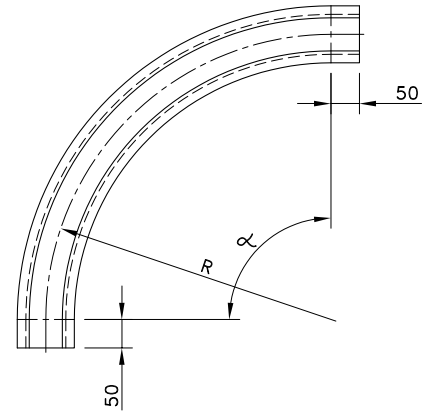

- For plastic Multiflex chains:
- 1700 TAB K
  - 1710 TAB K
  - 1713 TAB K

The code nr. includes both upper and under part.