

FlatTop Magnetflex® 1060

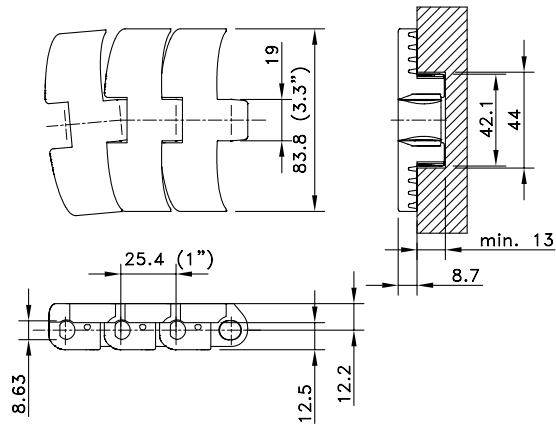

| Chain Type | Code Number | Plate Width A | | Weight kg/m | Sideflex Radius (min) mm | Working Load (max.) N (21°C) | Backflex Radius (min) mm | Plate Thickness mm |
|---|-------------|------------------|------|----------------|-----------------------------------|---------------------------------------|-----------------------------------|--------------------------|
| | | mm | inch | | | | | |
| XLG-Acetal | | | | | | | | |
| FTM 1060 XLG | 749.10.06 | 83.8 | 3.30 | 1.68 | 500 | 1900 | 130 | 8.7 |
| PSX Advanced Performance Polymer Alloy | | | | | | | | |
| FTM 1060 PSX | 749.10.49 | 83.8 | 3.30 | 1.68 | 500 | 1900 | 130 | 8.7 |
| BWX-Polyamide Composite | | | | | | | | |
| FTM 1060 BWX | 749.10.55 | 83.8 | 3.30 | 1.68 | 500 | 1900 | 130 | 8.7 |

Standard length: 3.048 m - 10 feet (120 links).

N(X) 1108

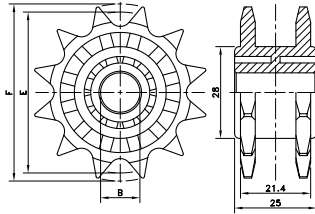

ST 1080

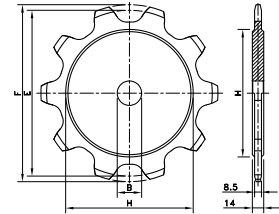

| Sprocket Type | Code Number | Number of Teeth | Bore | Pitch Diameter | Outside Diameter | Width (Teeth) | Hub Width | Hub Diameter |
|---------------|-------------|-----------------|---------|----------------|------------------|---------------|-----------|--------------|
| | | | B | E | F | C | A | H |
| | | | mm/inch | mm | mm | mm | mm | mm |

Classic Sprocket and Idler, Injection Moulded - N(X) 1108

| Sprocket, Metric Bore | | | | | | | | |
|-----------------------|-------------|----|----|------|------|------|------|------|
| N1108 12-12 | L1108666211 | 12 | 12 | 49.1 | 54.0 | 21.4 | 25.0 | 28.0 |
| Idler, Metric Bore | | | | | | | | |
| NX1108 12-12 | L1108666231 | 12 | 12 | 49.1 | 54.0 | 21.4 | 25.0 | 28.0 |

For plastic chain series: 1108.

The drive sprocket is fixed by mounting a pin radially through sprocket and shaft.

1108 plastic chains also run on standard 1/2" pitch roller chain sprockets that meet ANSI 40.

Classic Sprockets - ST 1080

| Metric Prebores | | | | | | | | |
|-----------------|-------------|----|----|-------|-------|-----|------|-------|
| ST1080 08-30 | L1080668371 | 8 | 30 | 165.9 | 177.7 | 8.5 | 14.0 | 119.0 |
| ST1080 09-30 | L1080668381 | 9 | 30 | 185.7 | 198.5 | 8.5 | 14.0 | 136.0 |
| ST1080 10-30 | L1080668391 | 10 | 30 | 205.5 | 219.3 | 8.5 | 14.0 | 158.0 |
| ST1080 12-30 | L1080668401 | 12 | 30 | 245.4 | 260.5 | 8.5 | 14.0 | 200.0 |
| ST1080 14-30 | L1080668411 | 14 | 30 | 285.4 | 301.5 | 8.5 | 14.0 | 240.0 |

For plastic chain series: 1080

SSW/SIW 1050

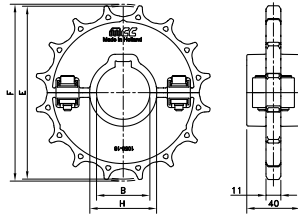

| Sprocket Type | Code Number | Number of Teeth | Bore | Pitch Diameter | Outside Diameter | Width (Teeth) | Hub Width | Hub Diameter |
|---------------|-------------|-----------------|---------|----------------|------------------|---------------|-----------|--------------|
| | | | B | E | F | C | A | H |
| | | | mm/inch | mm | mm | mm | mm | mm |

Split Sprockets and Idlers, Injection Moulded - SSW/SIW 1050

| Sprockets, Metric Bores | | | | | | | | |
|-------------------------|-----------|----|--------|-------|-------|------|------|------|
| SSW 1050 16-30 | 749.82.23 | 16 | 30 | 130.2 | 130.9 | 11.0 | 40.0 | 40.0 |
| SSW 1050 16-40 | 749.82.43 | 16 | 40 | 130.2 | 130.9 | 11.0 | 40.0 | 50.0 |
| SSW 1050 18-30 | 749.82.25 | 18 | 30 | 146.3 | 146.8 | 11.0 | 40.0 | 40.0 |
| SSW 1050 18-40 | 749.82.45 | 18 | 40 | 146.3 | 146.8 | 11.0 | 40.0 | 50.0 |
| Sprockets, Inch Bores | | | | | | | | |
| SSW 1050 16-1½ | 749.86.53 | 16 | 1.500" | 130.2 | 130.9 | 11.0 | 40.0 | 48.1 |
| SSW 1050 18-1½ | 749.86.55 | 18 | 1.500" | 146.3 | 146.8 | 11.0 | 40.0 | 48.1 |
| Idlers, Metric Bores | | | | | | | | |
| SIW 1050-16-30 | 749.81.23 | 16 | 30 | 131.2 | 130.9 | 11.0 | 40.0 | 40.0 |
| SIW 1050-16-40 | 749.81.43 | 16 | 40 | 131.2 | 130.9 | 11.0 | 40.0 | 50.0 |
| SIW 1050-18-30 | 749.81.25 | 18 | 30 | 147.4 | 146.8 | 11.0 | 40.0 | 40.0 |
| SIW 1050-18-40 | 749.81.45 | 18 | 40 | 147.4 | 146.8 | 11.0 | 40.0 | 50.0 |
| Idlers, Inch Bores | | | | | | | | |
| SIW 1050-16-1½ | 749.85.53 | 16 | 1.500" | 131.2 | 130.9 | 11.0 | 40.0 | 48.1 |
| SIW 1050-18-1½ | 749.85.55 | 18 | 1.500" | 147.4 | 146.8 | 11.0 | 40.0 | 48.1 |

For plastic chain series: 1050, 1055, 1060.

Magnetflex Version CIP4

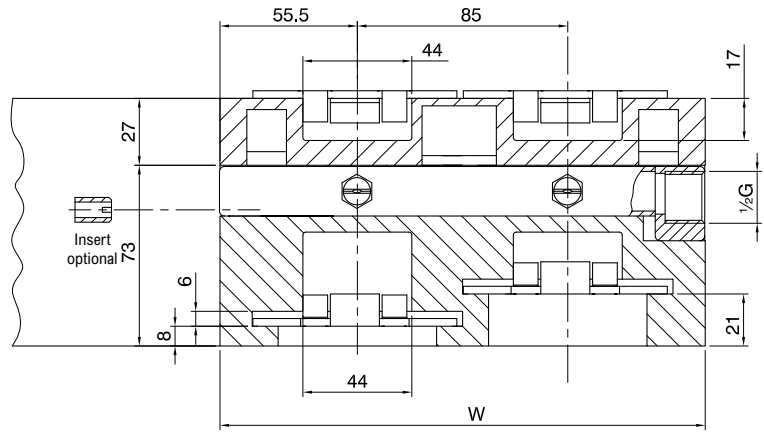

| Number of Tracks | 1 | 2 | 3 | 4 | 5 | 6 |
|------------------|--------|--------|--------|--------|--------|--------|
| Width W | 111 mm | 196 mm | 281 mm | 366 mm | 451 mm | 536 mm |

Version CIP4

| | | | | | | |
|-----|-----------|-----------|-----------|-----------|-----------|-----------|
| 15° | 785.45.16 | 785.45.17 | 785.45.18 | 785.45.19 | 785.45.20 | 785.45.21 |
| 30° | 785.45.31 | 785.45.32 | 785.45.33 | 785.45.34 | 785.45.35 | 785.45.36 |
| 45° | 785.45.46 | 785.45.47 | 785.45.48 | 785.45.49 | 785.45.50 | 785.45.51 |
| 60° | 785.45.61 | 785.45.62 | 785.45.63 | 785.45.64 | 785.45.65 | 785.45.66 |
| 75° | 785.45.76 | 785.45.77 | 785.45.78 | 785.45.79 | 785.45.80 | 785.45.81 |
| 90° | 785.45.01 | 785.45.02 | 785.45.03 | 785.45.04 | 785.45.05 | 785.45.06 |

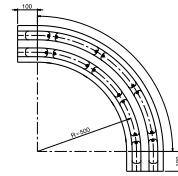

Radius

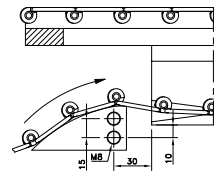

Return guide shoe

More than 6 tracks on request.

- For steel chains: 10/60/66 M 31 M, 60/66 M 31 XM, 66 M 31 RM, 60/66 M 84 XM.

Magnetflex Combi-A Version C5A-C5C

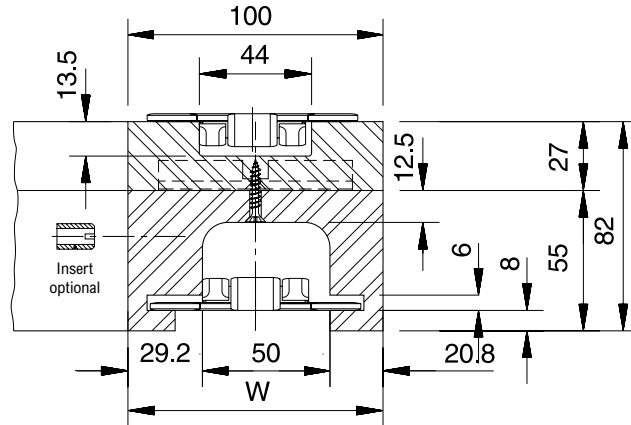

| Number of Tracks | 1 |
|------------------|--------|
| Width W | 100 mm |

Version C5A

| | |
|-----|-----------|
| 15° | 704.09.16 |
| 30° | 704.09.31 |
| 45° | 704.09.46 |
| 60° | 704.09.61 |
| 75° | 704.09.76 |
| 90° | 704.09.01 |

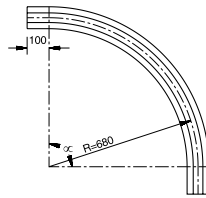

Radius

| Number of Tracks | 1 |
|------------------|--------|
| Width W | 100 mm |

Version C5C

| | |
|-----|-----------|
| 15° | 704.11.16 |
| 30° | 704.11.31 |
| 45° | 704.11.46 |
| 60° | 704.11.61 |
| 75° | 704.11.76 |
| 90° | 704.11.01 |

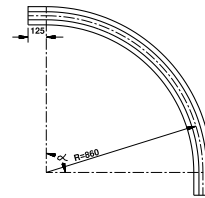

Radius

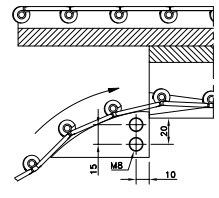

Return guide shoe for C5A-C5C

More than 1 track on request.

- For steel chains: 10/60/66 M 31 M, 60/66 M 31 SM, 66 M 31 RM, 60/66 M 84 SM.
- For plastic chains: RHMP 325, RHMDP 325, RHMP 84.

More than 1 track on request.

- For steel chains: 10/60/66 M 31 M, 60/66 M 31 SM, 66 M 31 RM, 60/66 M 84 SM, SSC 581 M-K325.
- For plastic chains: RHMP 325, RHMDP 325, RHMP 84.